

DATE	DRN
4/25/2012	KDS

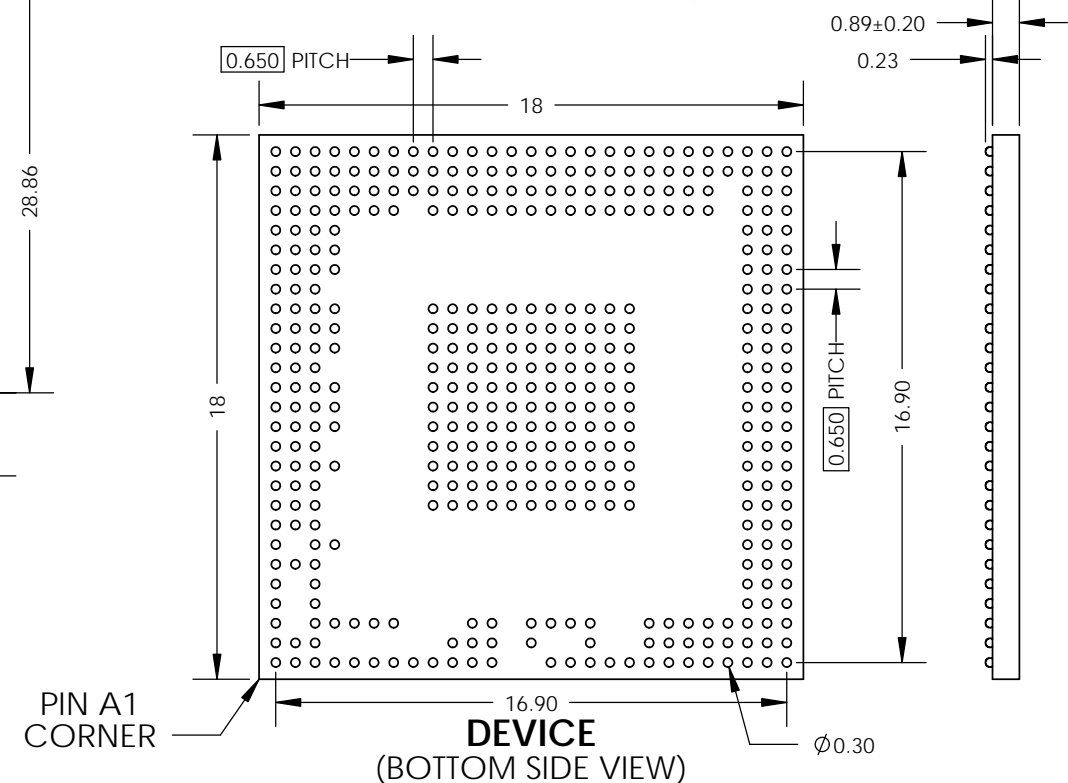
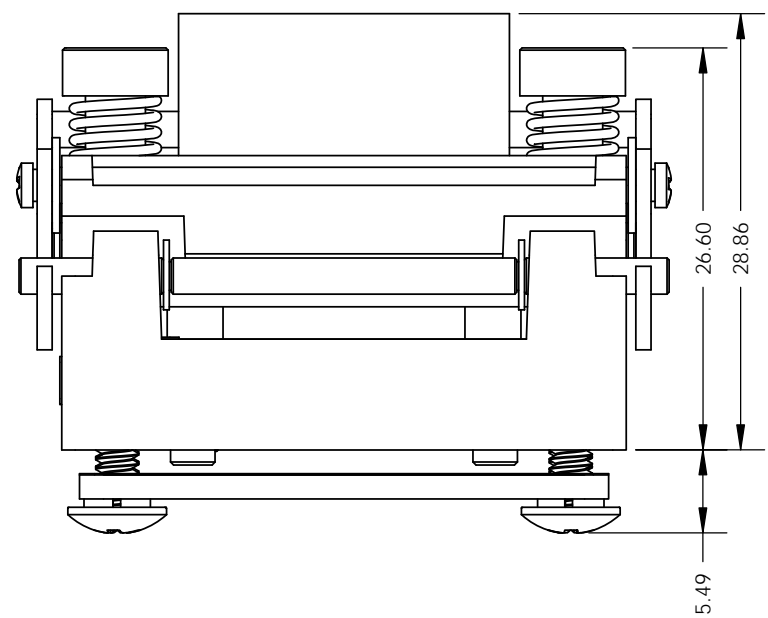
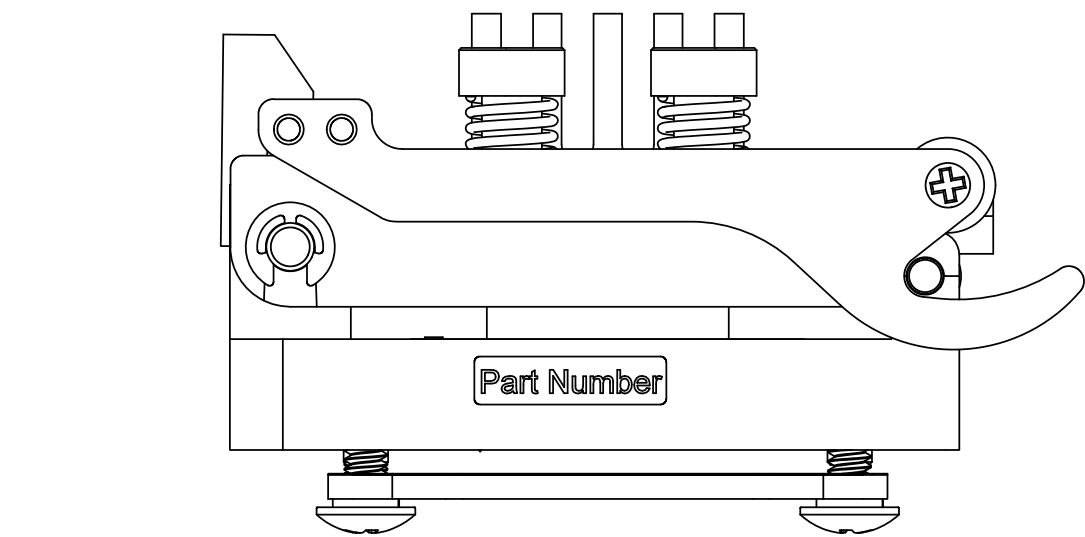
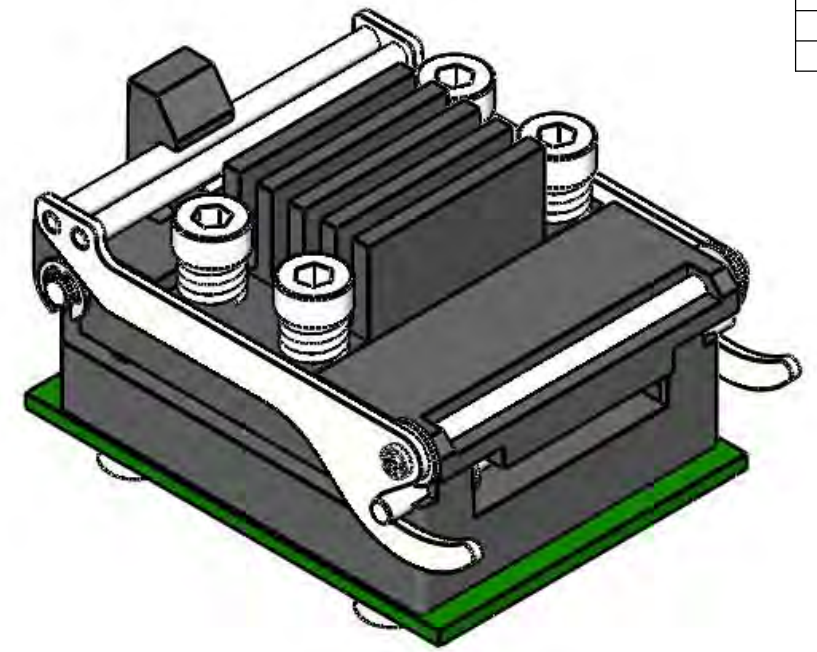
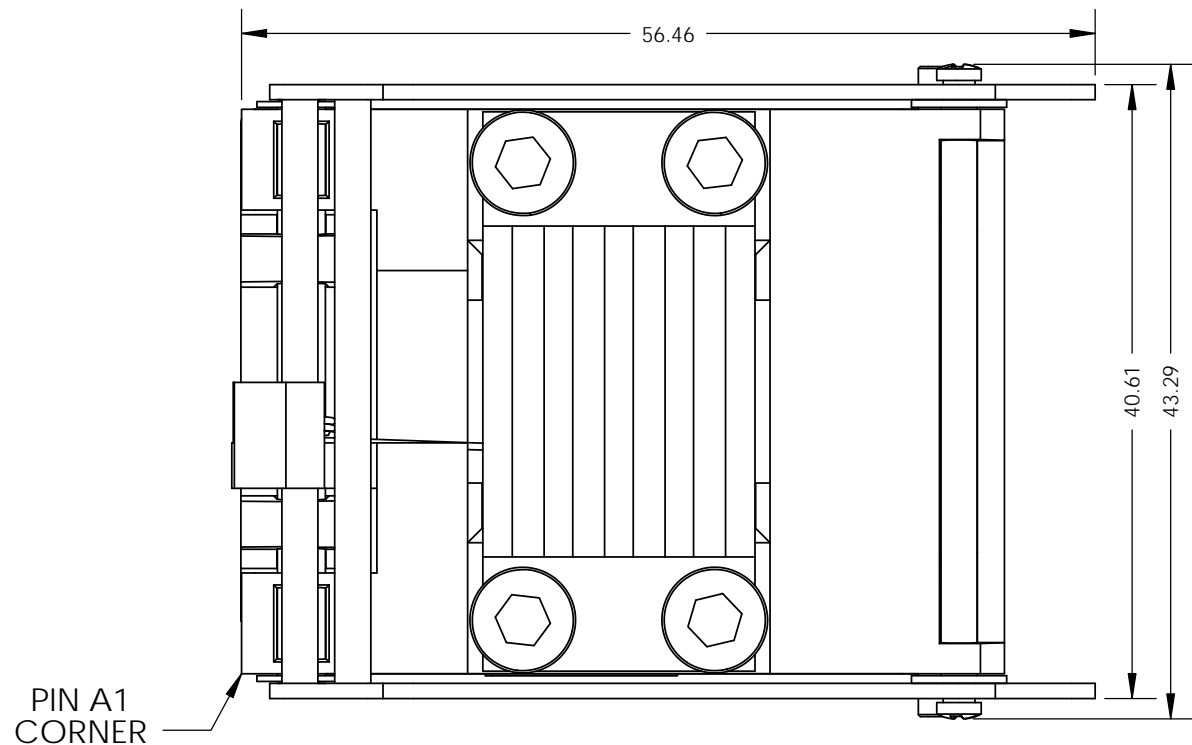

NOTES:

1. PCB PAD PLATING: 30  $\mu$ in. HARD Au OVER 300  $\mu$ in. Ni OVER 1oz. MIN. Cu
2. CONTACT PLATING: 30  $\mu$ in. Au OVER 75  $\mu$ in. Ni
3. CONTACT FORCE: 30gF
4. MAX OPERATING TEMP: 150°C
5. CONTACT RESISTANCE: < 30 m $\Omega$
6. PLASTIC MATERIAL: ULTEM 2210EPR
7. HANDLE MATERIAL: 304 STAINLESS
8. HEATSINK/PUSHER: 6063-T5 ALUMINUM, BLACK ANODIZED
9. SOCKET SHOULD FIT FREELY INTO PCB.
10. NO FILLED VIAS. VIAS MUST BE OFFSET FROM PADS.

- FEATURES:
- CONTACT = H038DL1A
  - DEVICE THICKNESS (LESS BALLS) = ( 0.89 )
  - STEEL BACK-UP PLATE
  - 3 PLATE FLOATING BGA SYSTEM
  - SPRING LOADED PUSHER/HEAT SINK
  - CROSS-FLOW FIN ORIENTATION
  - HANDLE LATCH

P/N: 415BESM65Y01

PROPRIETARY

THIS DRAWING IS SUBJECT TO CHANGE WITHOUT NOTICE. PLEASE REQUEST A CURRENT DRAWING WHEN LAYING OUT BOARDS.	SIZE: B	NAME	DATE	DWG NO. S415BESM65Y01	SHEET 1 OF 3
	DRAWN	KDS	04/25/2012	TITLE: ESM SERIES ASSY, 18.0 x 18.0mm DEVICE, 0.65mm PITCH, 415x 0.50mm H-PINS	
SCALE: VARIOUS	CHECKED				
UNITS: mmgs	ENG APPR.				
SOLIDWORKS CREATED FILE	MFG APPR.				

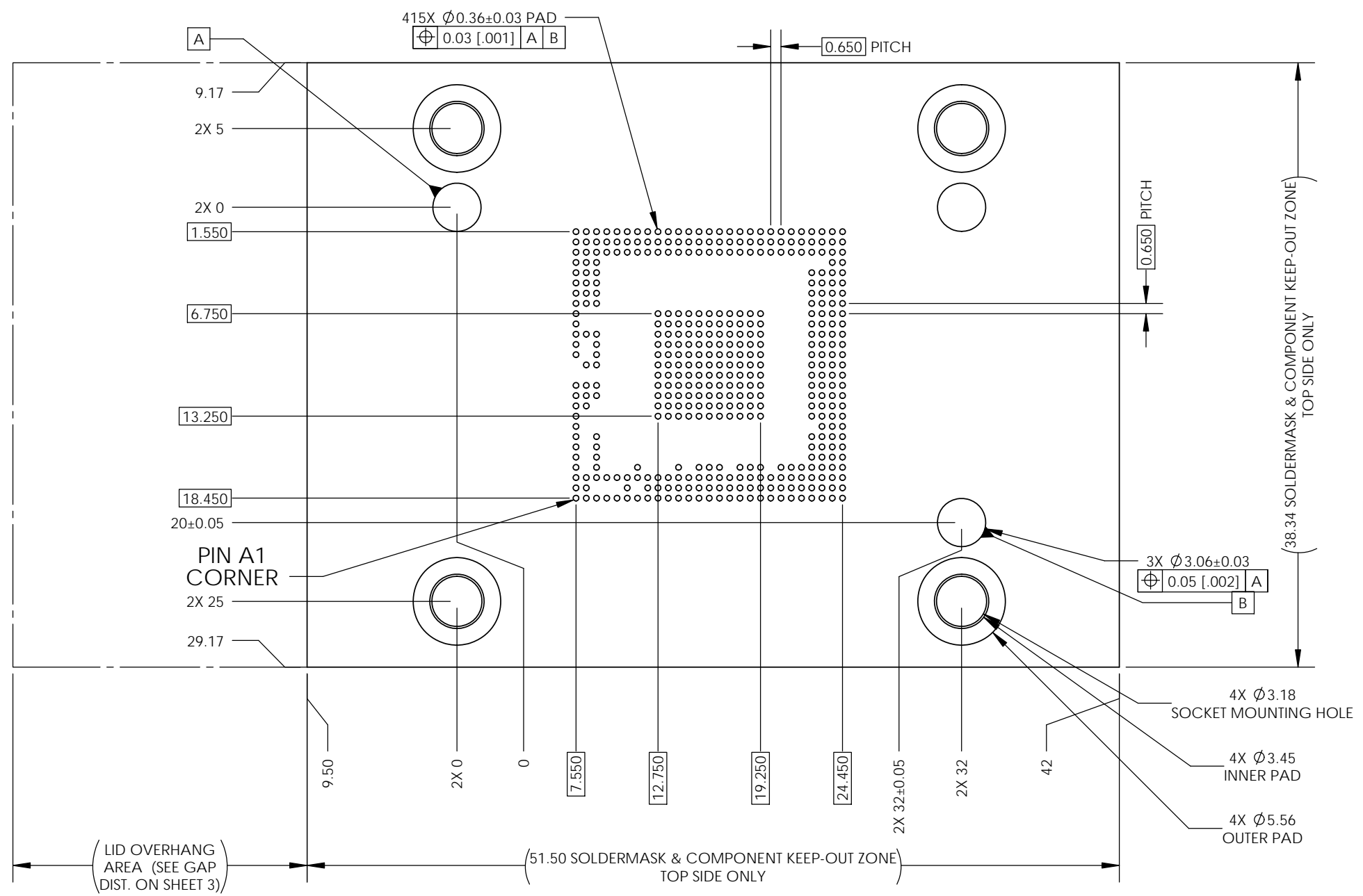

**PCB LAYOUT**  
(TOP SIDE VIEW)

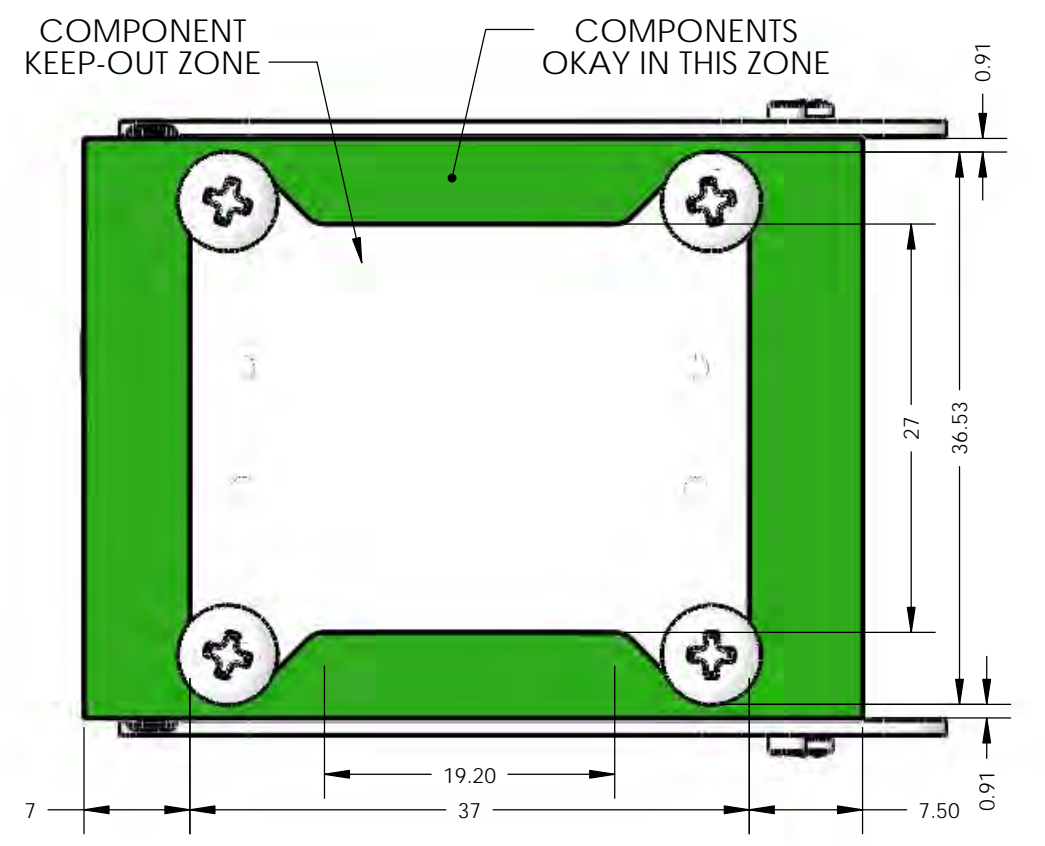

**Z-AXIS COMPONENT KEEP OUT ZONE**  
(BOTTOM SIDE VIEW)

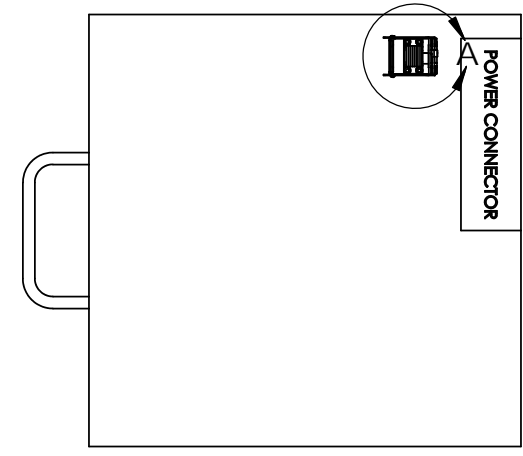
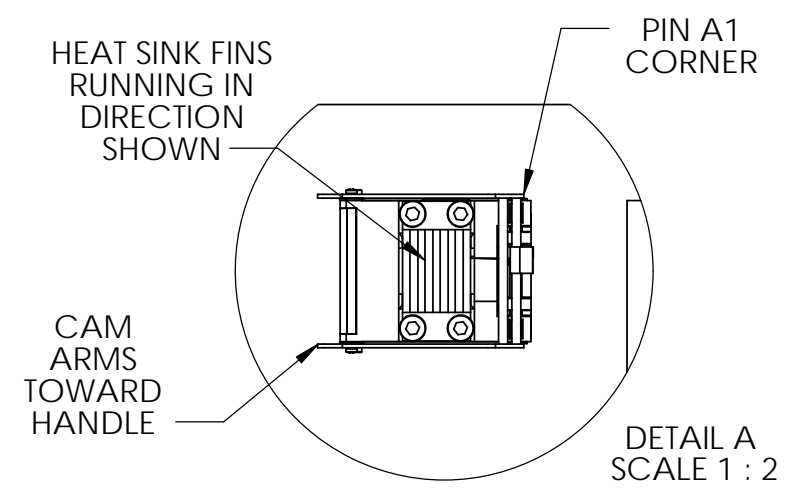

**BOARD TO OVEN ORIENTATION**  
(TOP SIDE VIEW)

P/N: 415BESM65Y01

PROPRIETARY

THIS DRAWING IS SUBJECT TO CHANGE WITHOUT NOTICE. PLEASE REQUEST A CURRENT DRAWING WHEN LAYING OUT BOARDS.	SIZE: B	NAME	DATE	DWG NO. S415BESM65Y01	SHEET 2 OF 3
	DRAWN	KDS	04/25/2012	TITLE:	
SCALE: VARIOUS	CHECKED			ESM SERIES ASSY, 18.0 x 18.0mm DEVICE, 0.65mm PITCH, 415x 0.50mm H-PINS	
UNITS: mmgs	ENG APPR.			2601 Texas Drive Irving, TX 75062	
SOLIDWORKS CREATED FILE	MFG APPR.				

ASSEMBLY INSTRUCTIONS:

1. ALIGN SOCKET ONTO TOP OF PCB USING 3 ALIGNMENT FEATURES.
2. ON BOTTOM SIDE OF PCB, LINE UP BACK-UP PLATE (W/ KAPTON TAPE SIDE UP).
3. ADD 4X LOCK WASHERS AND 4X SCREWS. USE #1 PHILLIPS TO TIGHTEN.
4. DO **NOT** LOCTITE THESE SCREWS.

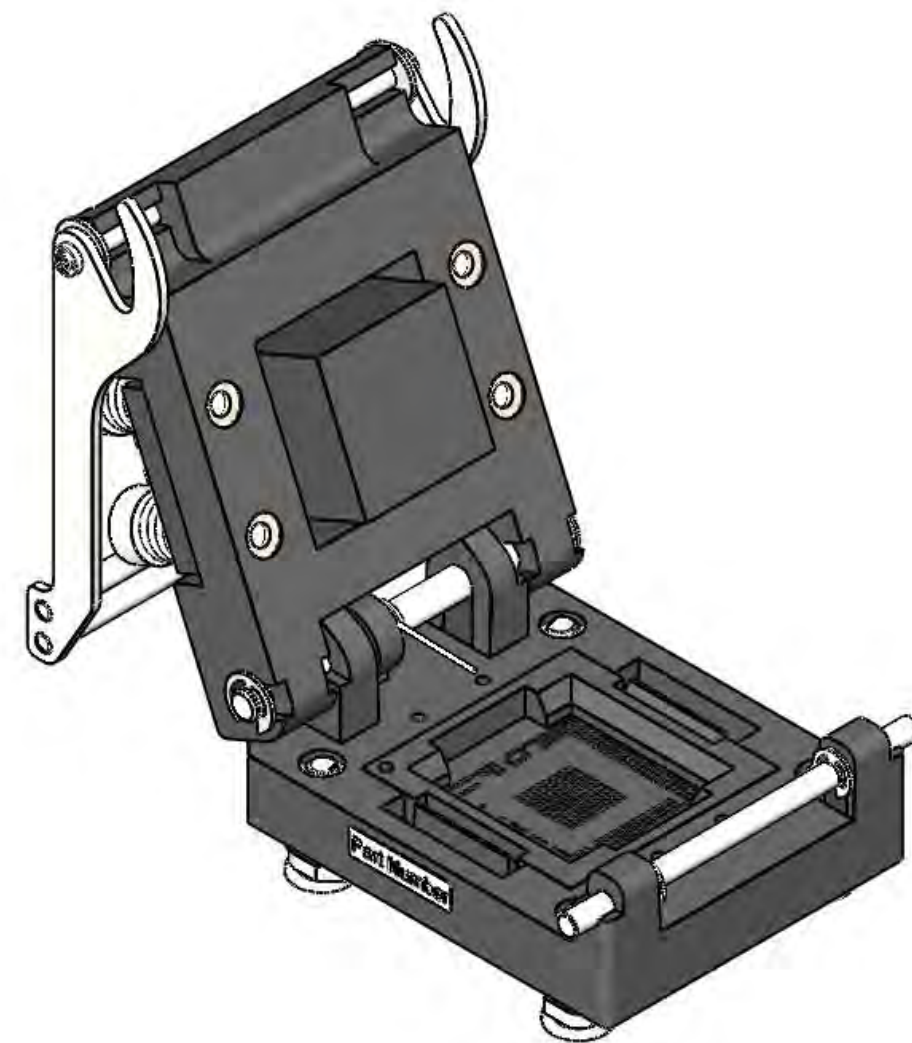
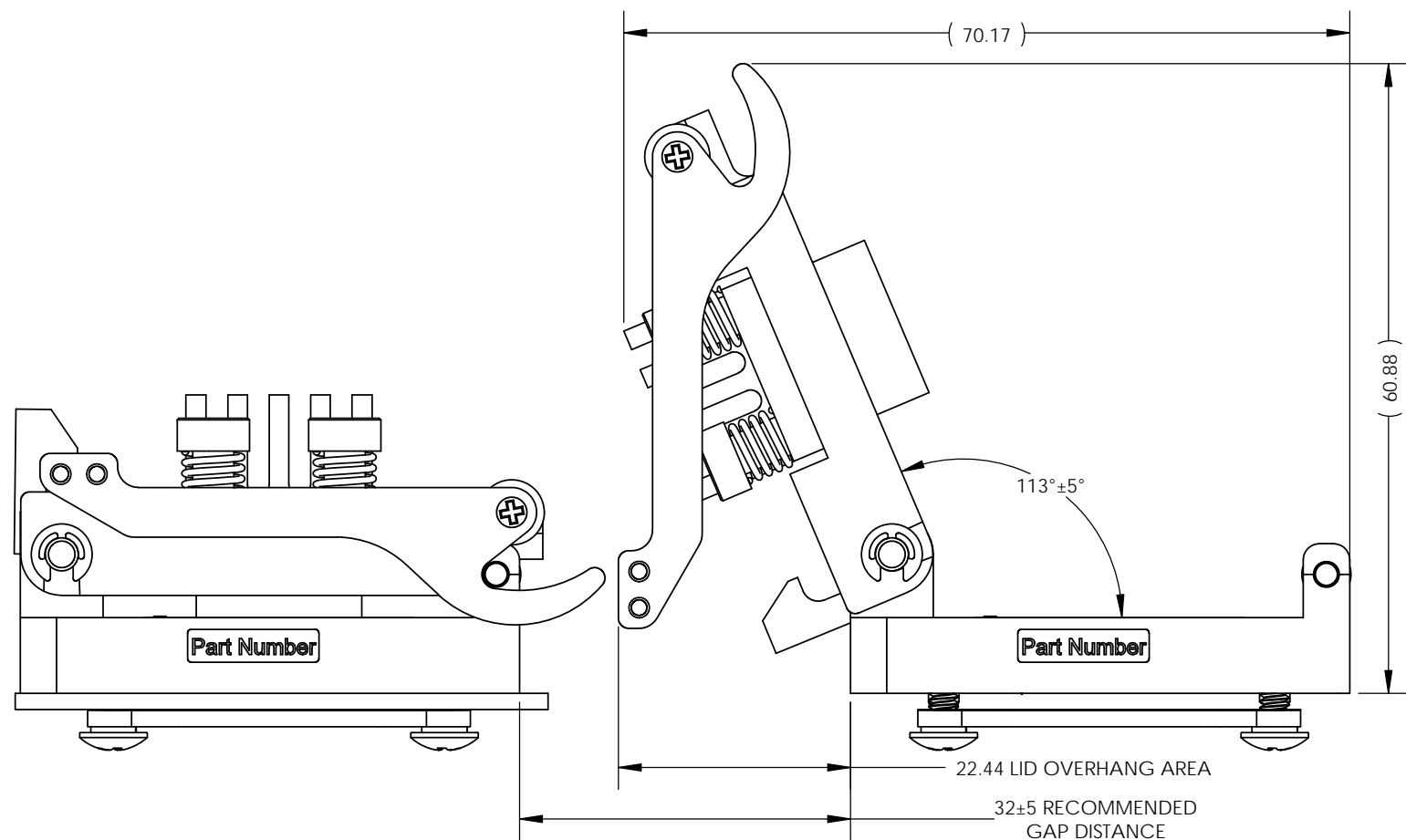
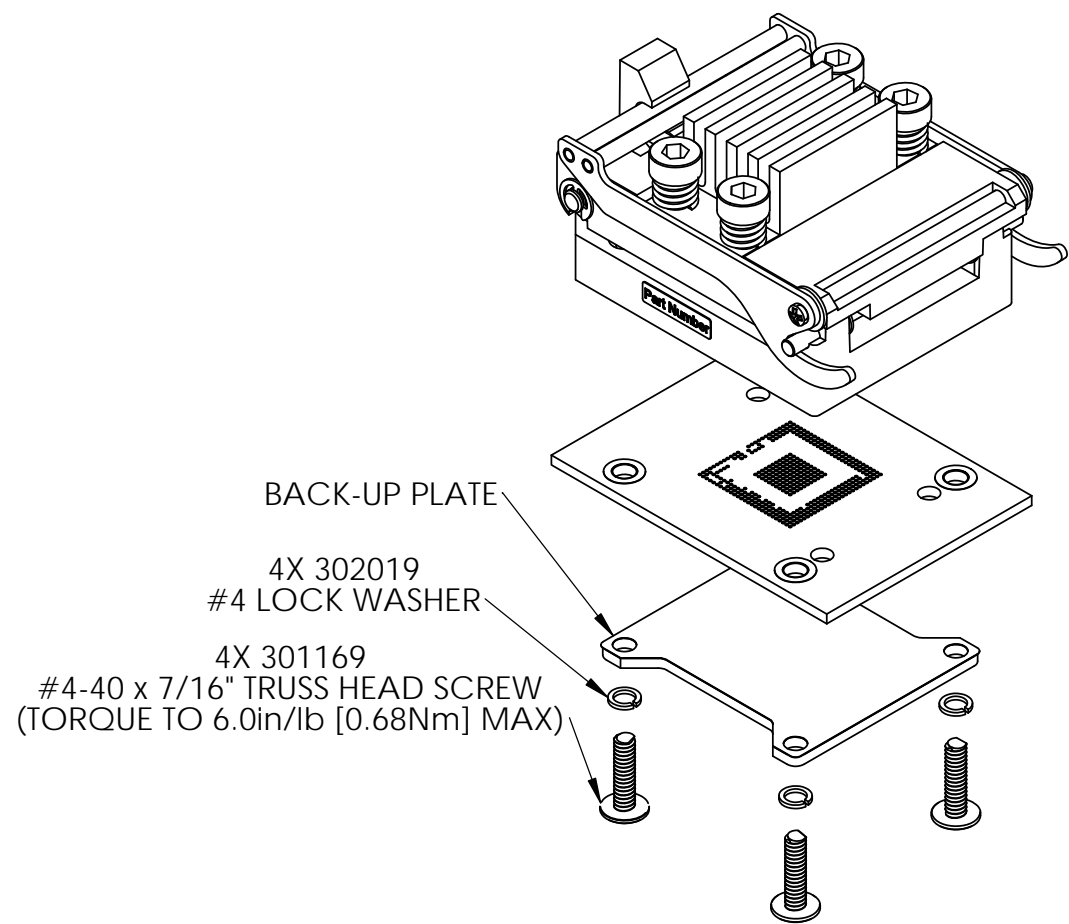

P/N: 415BESM65Y01

PROPRIETARY

THIS DRAWING IS SUBJECT TO CHANGE WITHOUT NOTICE. PLEASE REQUEST A CURRENT DRAWING WHEN LAYING OUT BOARDS.	SIZE: B	NAME	DATE	DWG NO. S415BESM65Y01	SHEET 3 OF 3
	DRAWN	KDS	04/25/2012	TITLE: ESM SERIES ASSY, 18.0 x 18.0mm DEVICE, 0.65mm PITCH, 415x 0.50mm H-PINS	
SCALE: VARIOUS	CHECKED			<b>PLASTRONICS</b> 2601 Texas Drive <b>SOCKETS &amp; CONNECTORS</b> Irving, TX 75062	
UNITS: mmgs	ENG APPR.				
SOLIDWORKS CREATED FILE	MFG APPR.				